

WALK FIVE:

THE HARBOUR

WALK FIVE: THE HARBOUR

On the 17 May 2017 a group of 12 pupils of varying ages from St Peter's School took time out from their usual studies to explore the area around Folkestone Harbour. This was the fifth and final walk of this series and was aimed at including a record of the opinions of some younger citizens of Folkestone about their town.

St Peter's School sits above, and to the east of, the town overlooking

the harbour. The walk, from the school gates to the Urban Room on the Harbour Arm, was an opportunity for the pupils to explore in more detail an area with which they were already very familiar.

After a picnic lunch taken in the Urban Room, the group was invited to record their impressions from the walk and to make recommendations for improvements that should be considered. Their vivid impressions

and robust, clear proposals are recorded in the sketches and statements set out in the pages that follow this introduction.



THE WALK

The route of the Walk Five comprised:

St Peter's School
East Leas
Steps to East Street
East Street
The Stade
Fish Market
Beach Street

Harbour Approach Road
The Harbour Arm
The Urban Room



THE WALKERS



St Peter's School Crafted brickwork



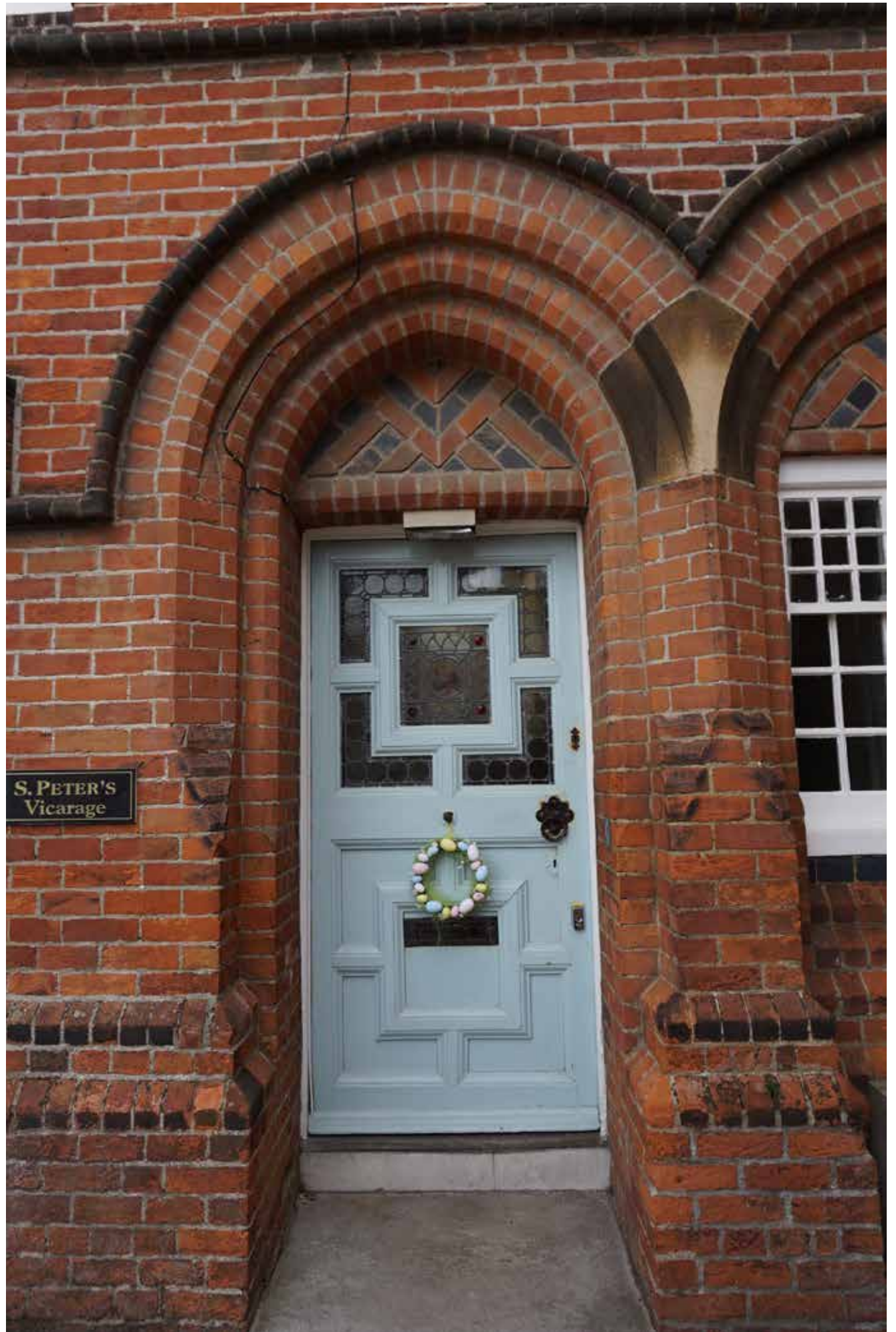

St Peter's Vicarage



The harbour with dredging in progress



Anchors on the harbour bed



Old wheels



The Five Walks film crew



Outer harbour wall The St Peter's pupils suggested that this wall should be opened up for public access in a similar way to the popular Harbour Arm seen in the distance



The Grand Burstin Hotel The pupils suggested many ideas for improving the building such as opening the roof deck for helicopters, repainting, and changing the windows. Some felt demolition was the only option



Glorious mud



Inner harbour at low tide



The River Pent outfall to the sea The St Peters pupils suggested that the waters may be medicinal and could be bottled. Some expressed a strong dislike of seagulls - particularly their noisy and greedy habits



Exploring the inner harbour



Boats in the harbour



Restoration of the Harbour Rail Viaduct
in progress as part of the works to open
the track bed as a public route across
the harbour



Car park and cliffs



Lunch in the Urban Room



View back to St Peter's School from the Urban Room. The playground can be seen in the centre of the photograph



Recording impressions



Heading back to school

IMPRESSIONS

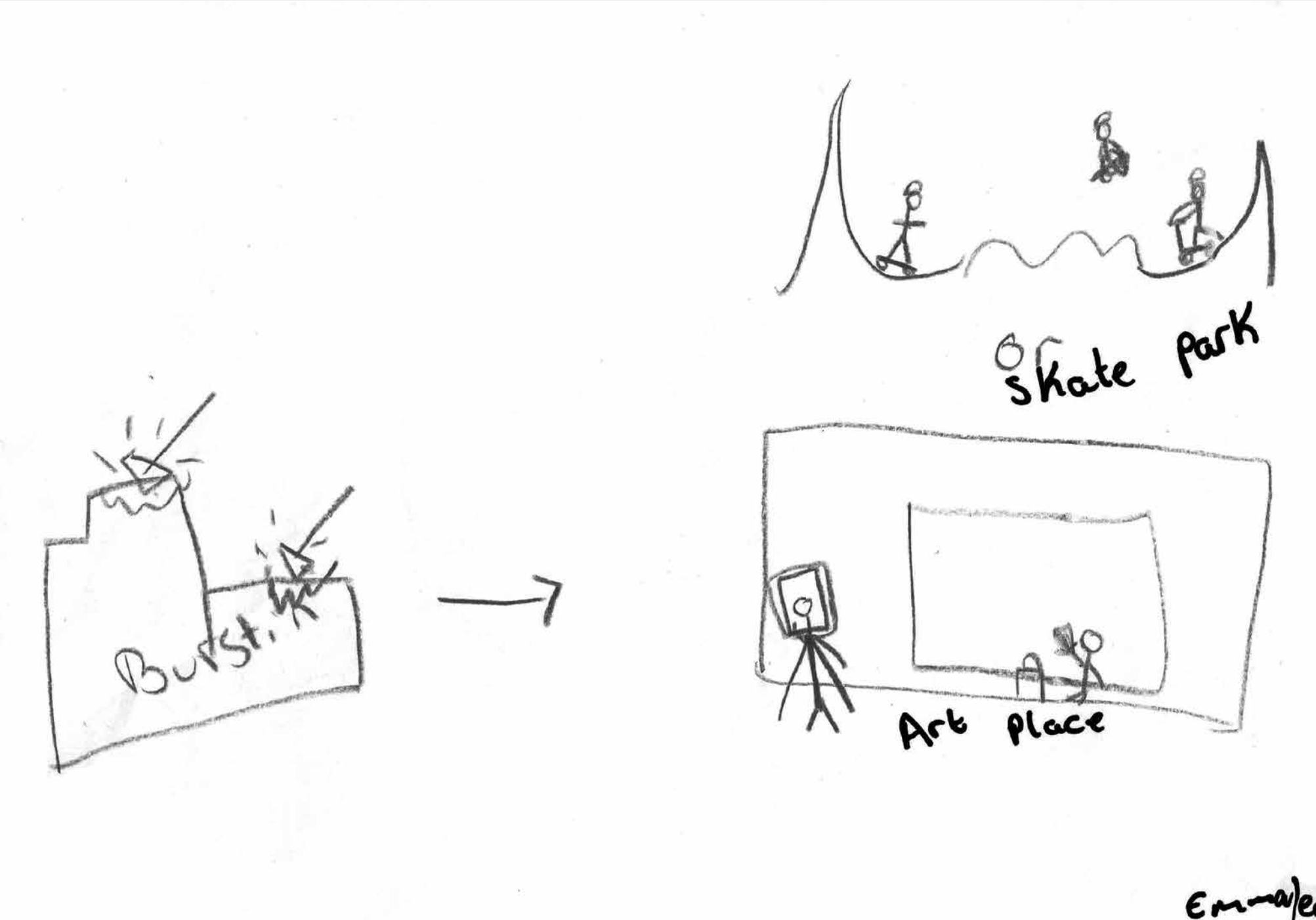

Buncking

I recom that the Buncking
SHOULD be a changed to
a skate park because The new
skate park is going to
be built in two years will

^{Libby}
Make the couch park
into ~~the~~ a play area
or tennis course



Harbour arm sign bigger &
better advertisement



will

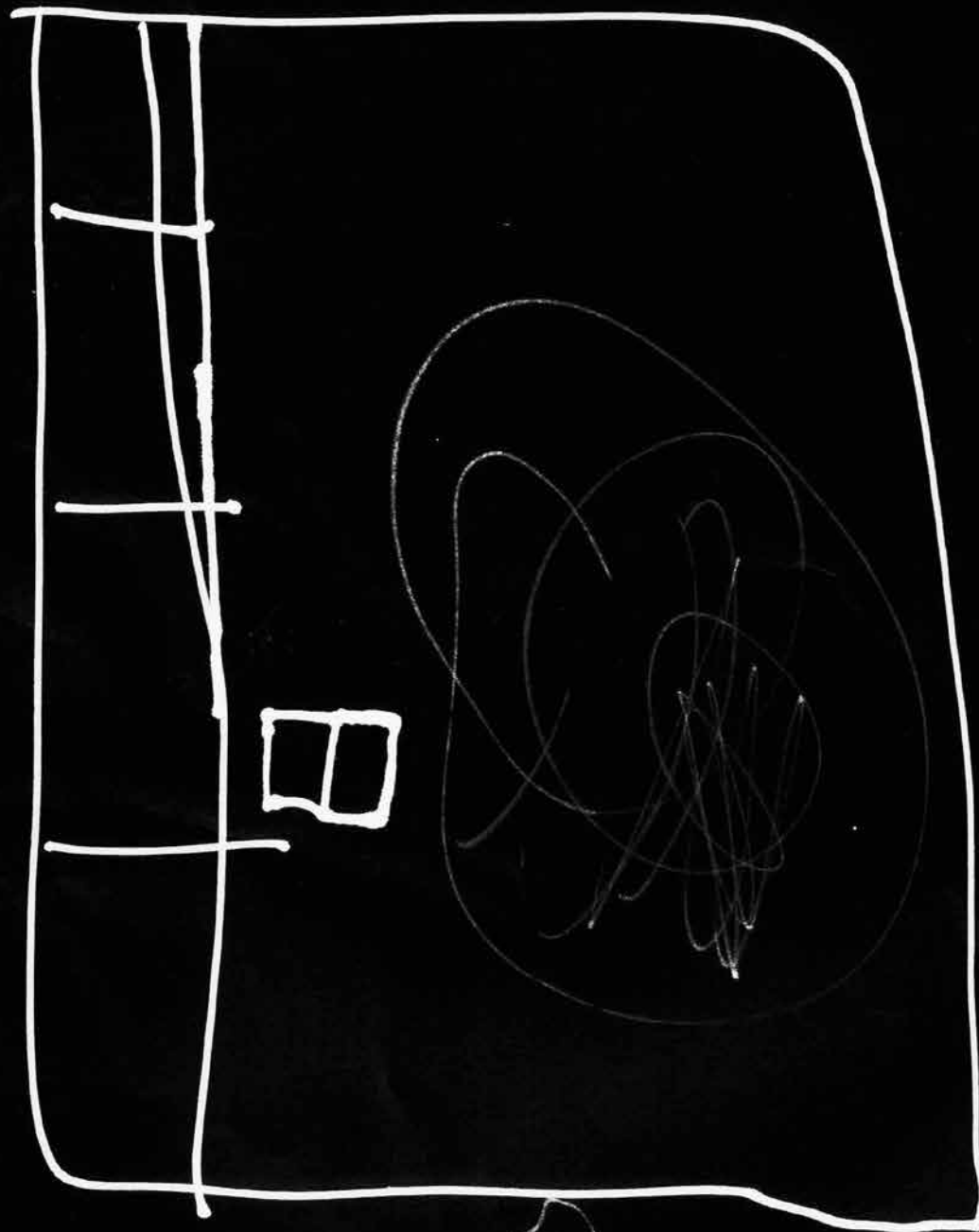

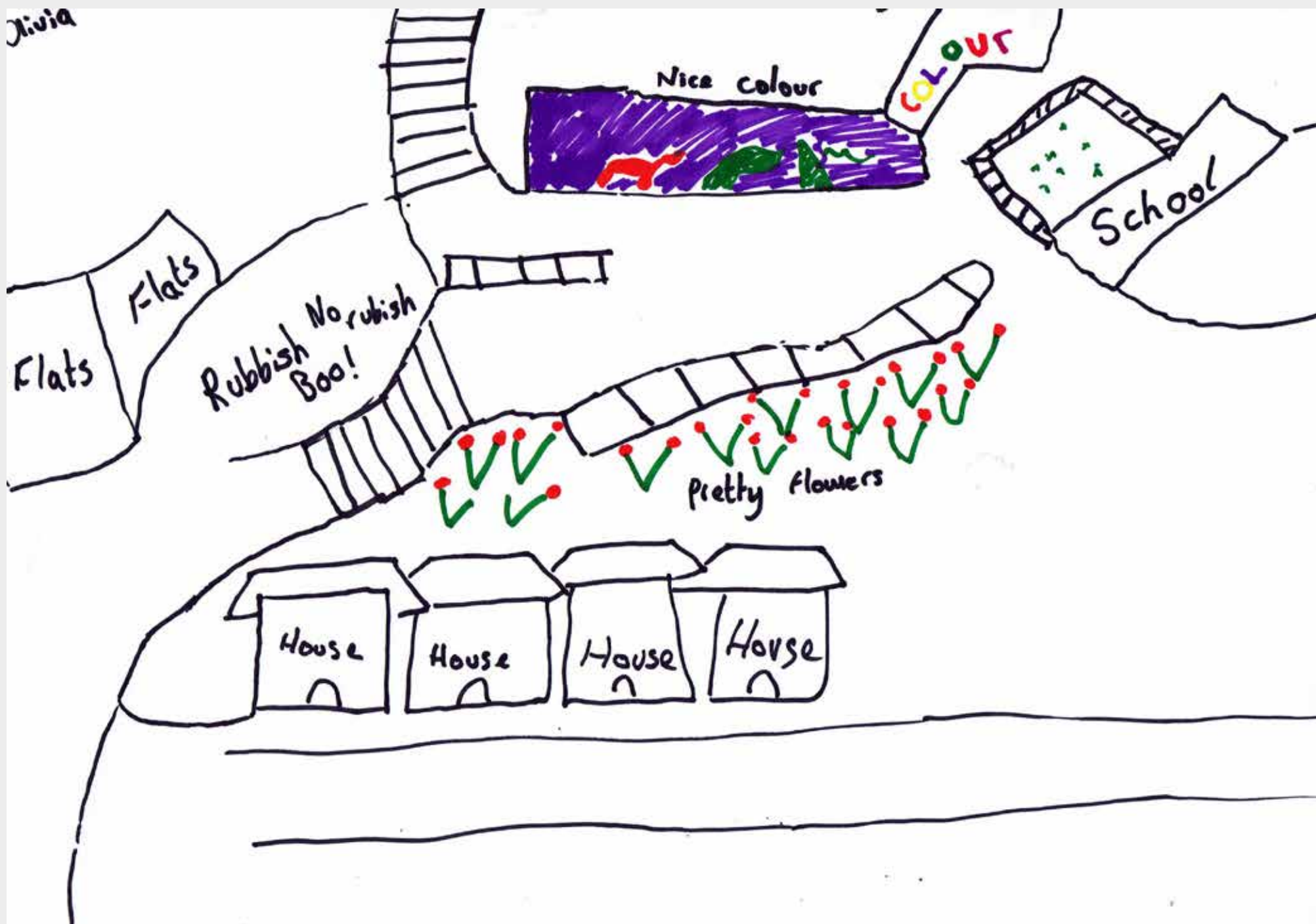

I think that they should make a massive Sports
Centre where the ^{coaches} ~~top~~ park is, because not many
~~people~~ ^{children} come in anymore.

Sports Centre

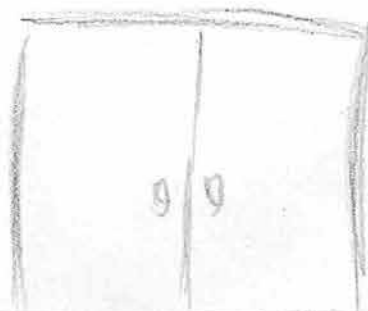
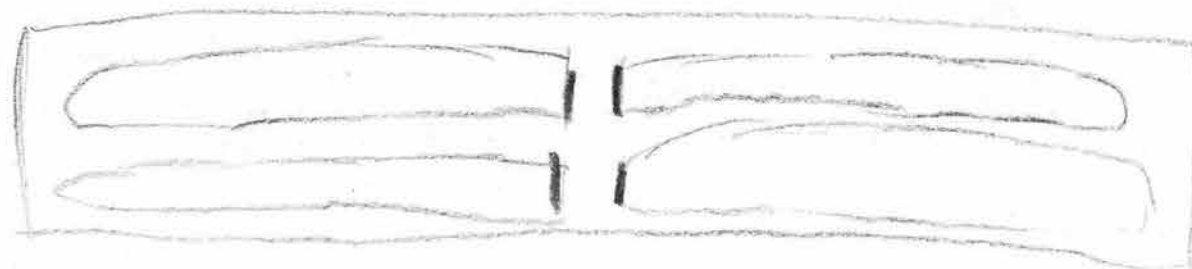

Lilly

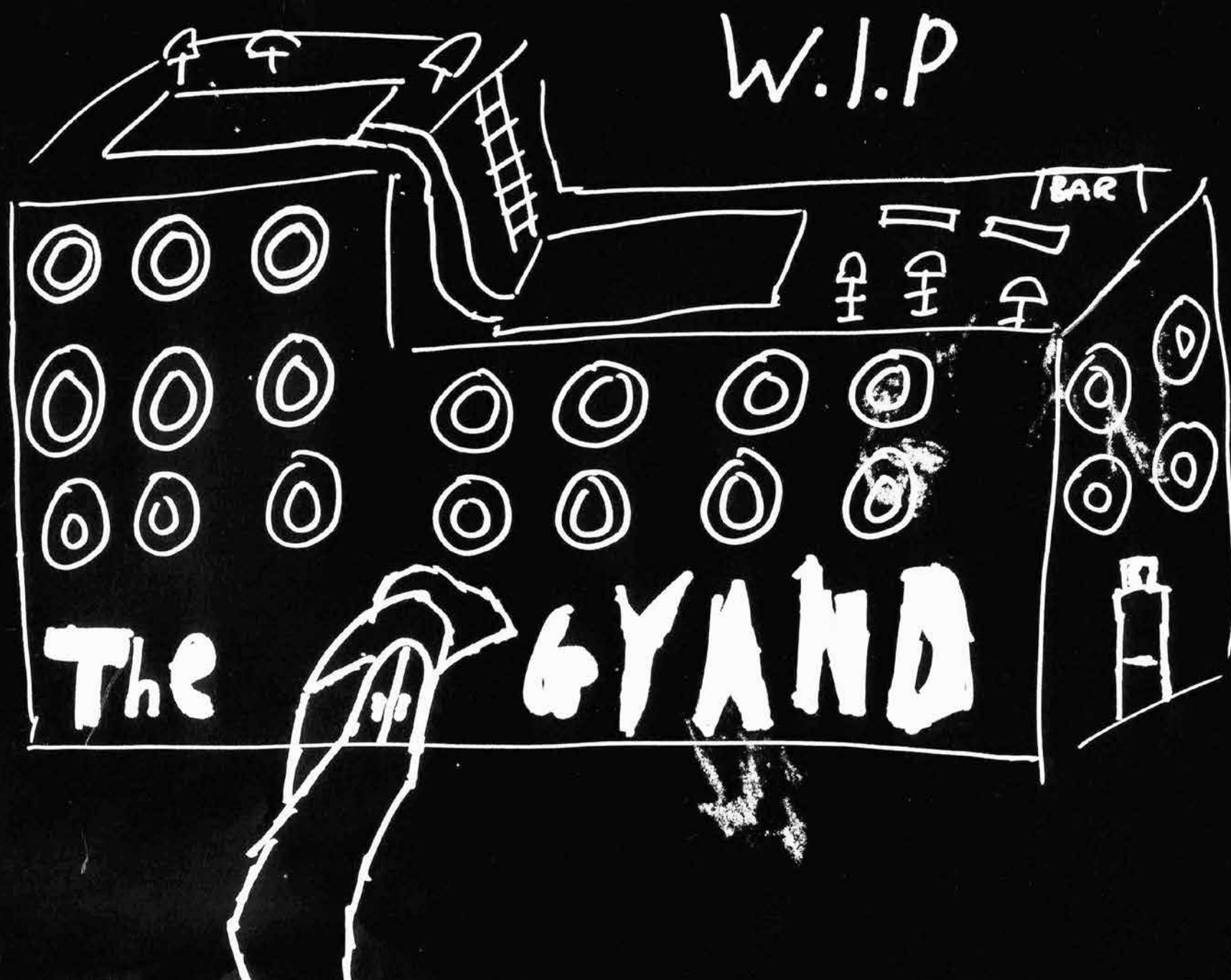

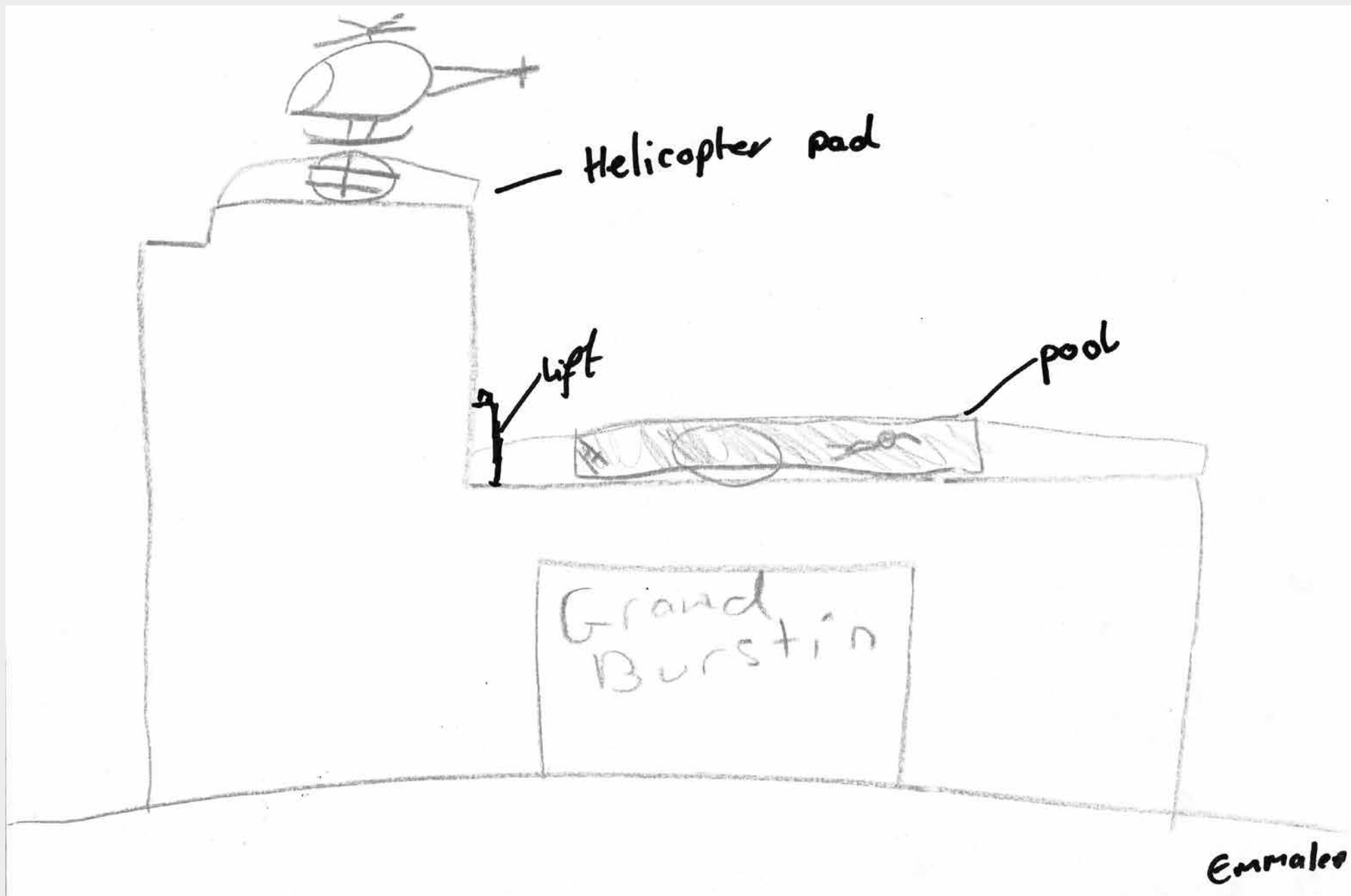



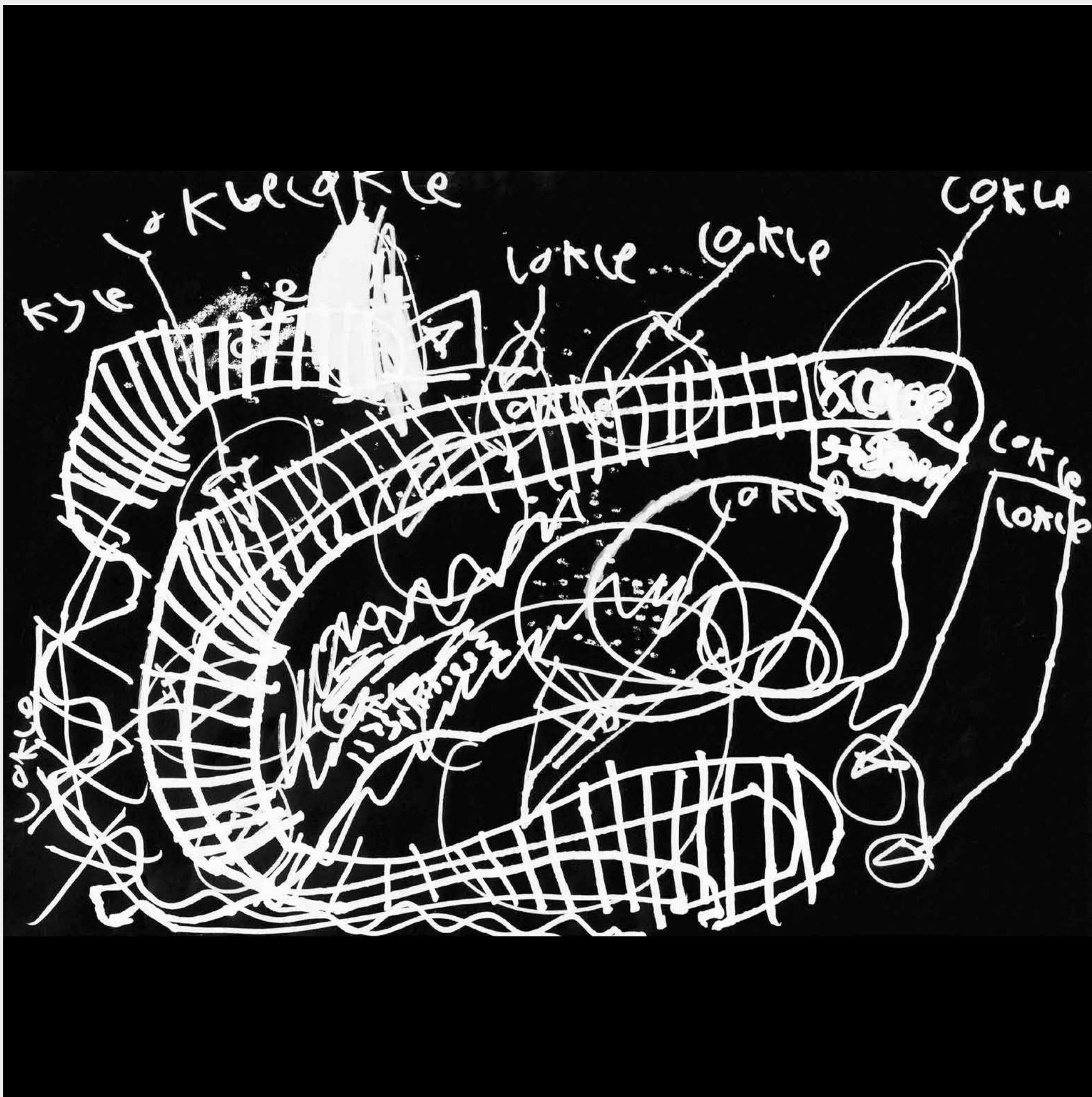

The Shelters of Kypess

plan. Kyle

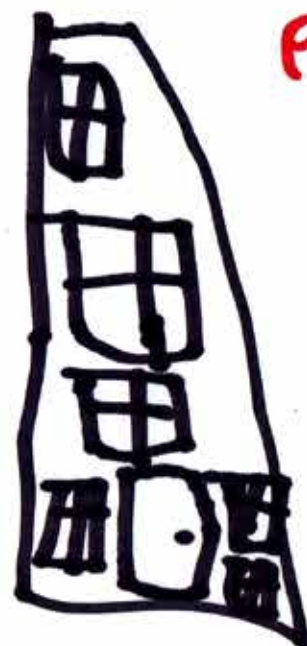

I'm adding six
more water fountains



Caution



Caution

Bird watching

We can ~~turn~~ not
see all the
amazing birds
So bird watching
is what we need.

Amelia

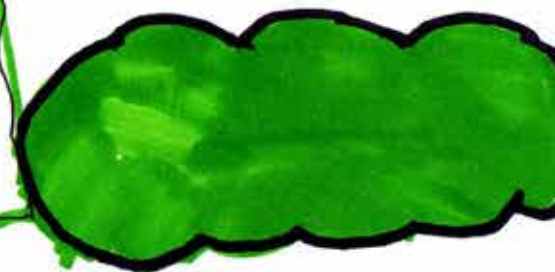

Boat

Rubish

Rubish

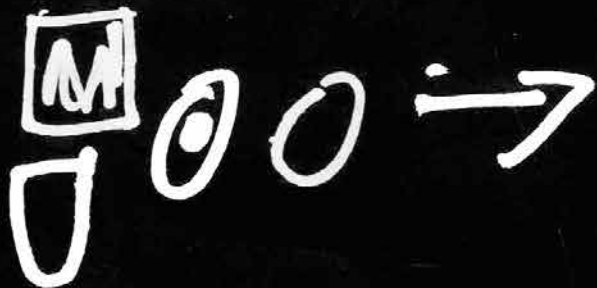

Bursting

needs a kneel
Signs.

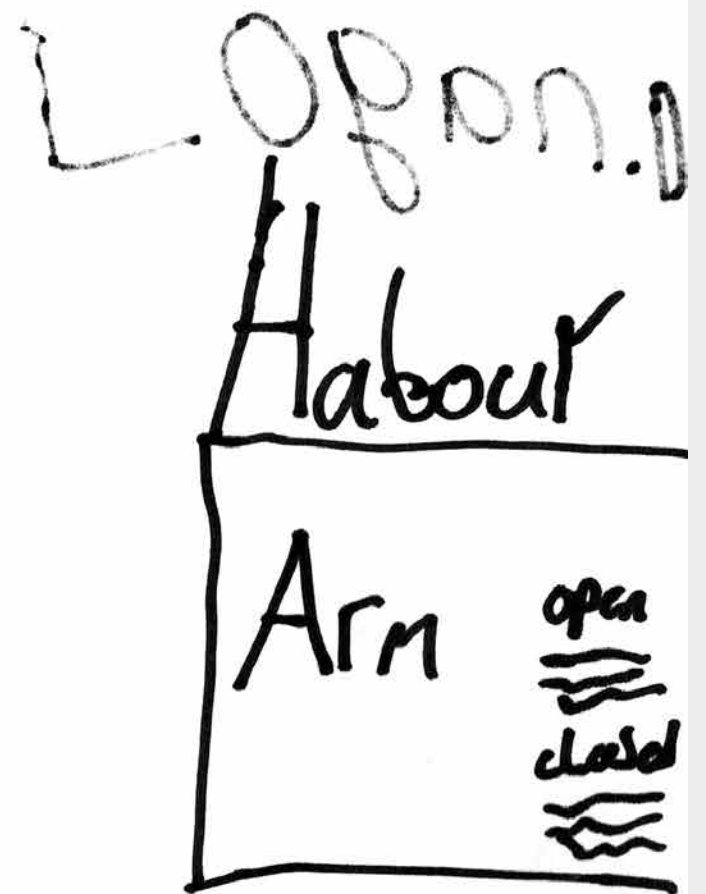
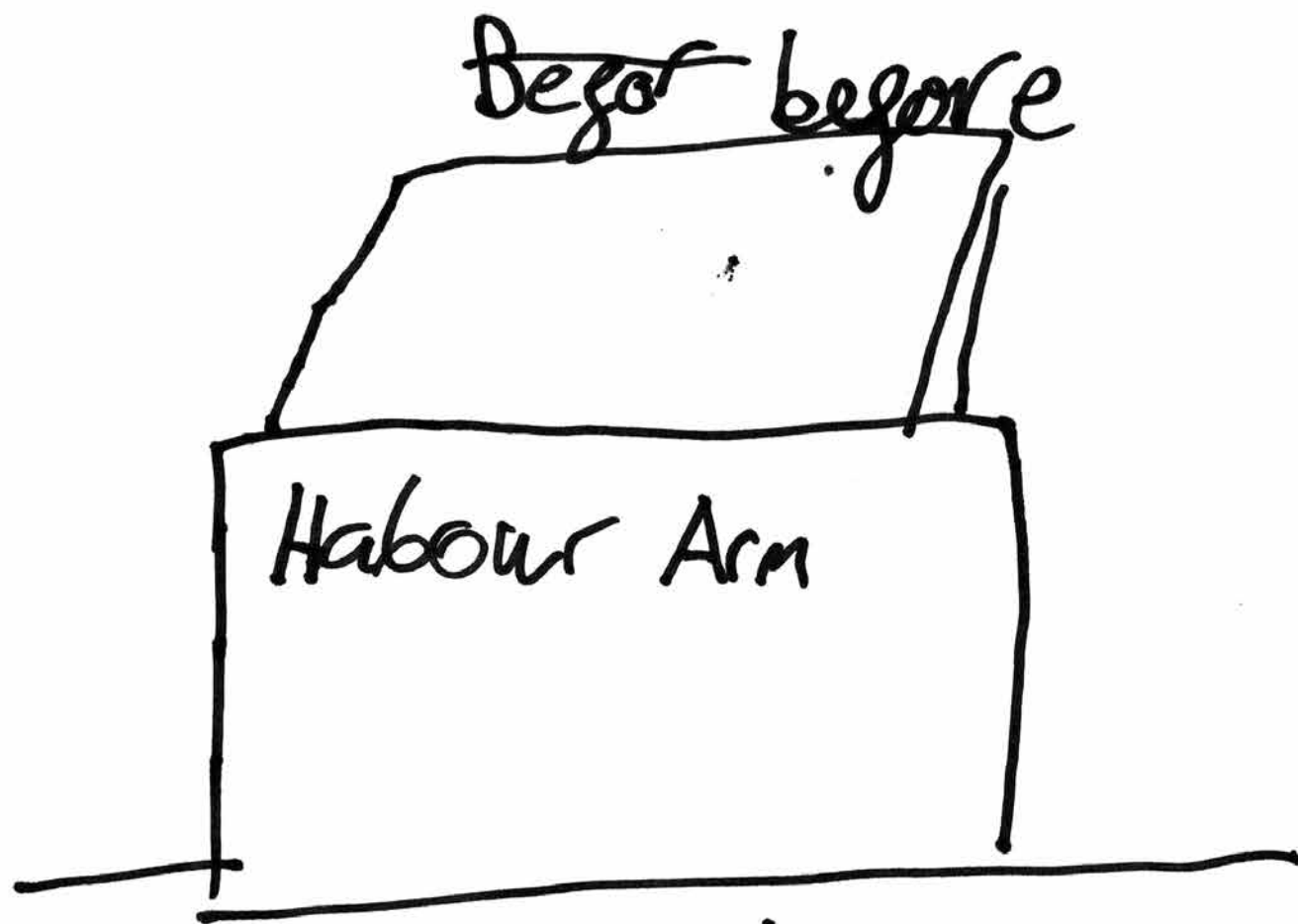

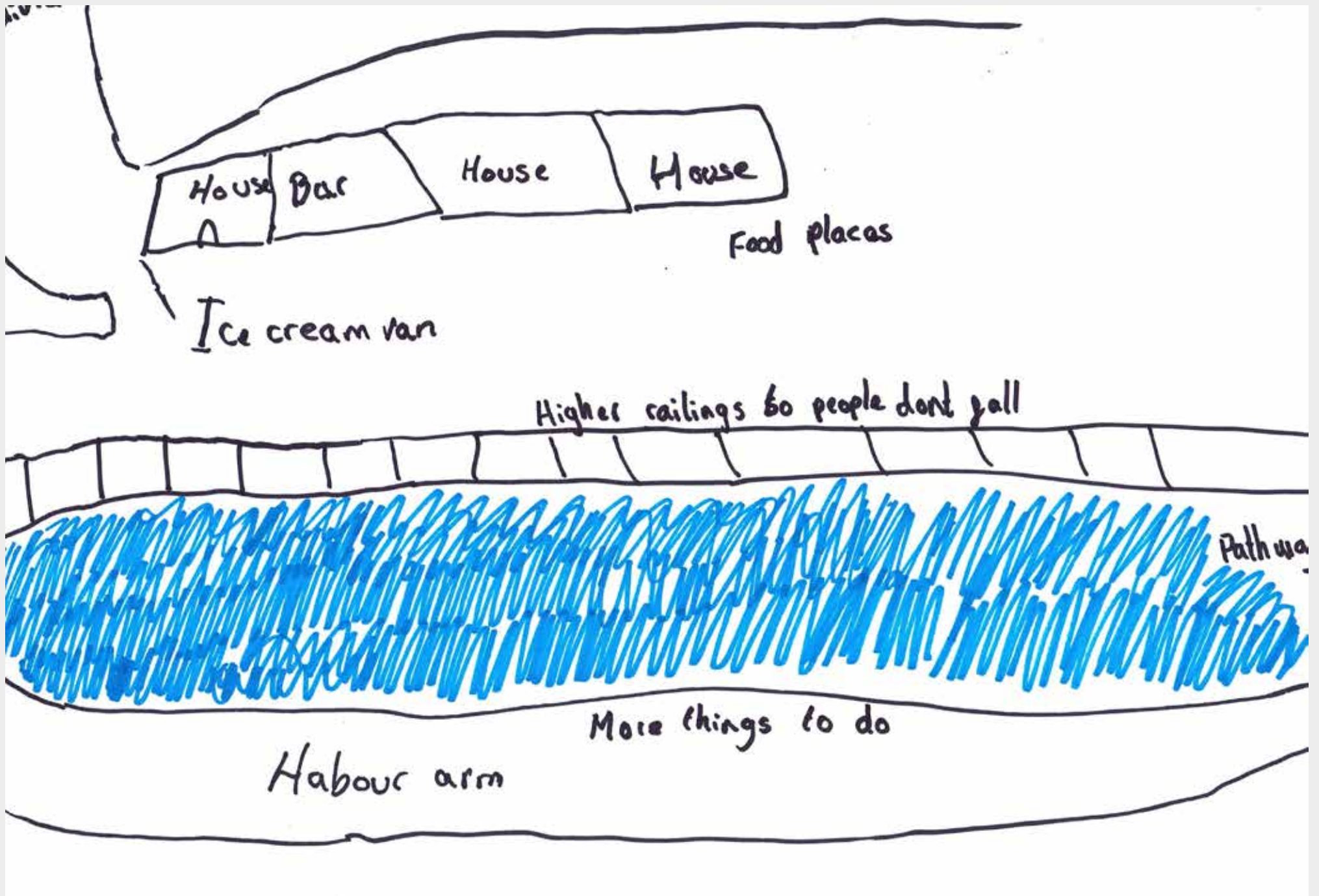

I think the Habour Arm Sign can be improved to be more appealing for tourists



Andis there will be a wall that people can graffiti on.



- 1) Have more fountains 
- 2) Get more faceholes → 
6. Have more ice-cream shops

THIS SHEET
BELONGS
TO:
LEXI MAY
GOODALL

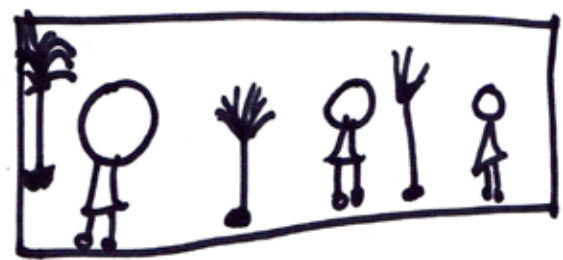

- 1) Change the Burstin's name to The Folkestone Grand
- 2) Clear up the beach - Sunny Sands -
- 3) In the summer, make the fountains automatically turn on.
5. In the winter, make the fountains automatically turn off





Vote for keeping Burslin or not dibby
repaint It or clean It.

More thingy to do in Jolkestone
fountains back

No gragity!

No gly tipping

Kill the seagulls



Make a nother ^{harbour} walk across
Or be able to walk across

on the break water

gragity on arches



Grassiey walls because there
is so much grassiey ~~everywhere~~ everywhere
the grassiey walls can stop that from happening.



Places to put the wall...

~~Far from the~~
-old Skate Park
costume park

Maisy-
Jane



↓ clean up

